

Pressure transmitter for general applications

Model S-10, standard version

Model S-11, flush diaphragm

Data Sheet PE 81.01

Applications

- Mechanical engineering
- Hydraulics / Pneumatics
- General industrial applications
- Food industries

Special Features

- Pressure ranges from 0 ... 0.1bar to 0 ... 1000 bar
- Various industrial standard signal outputs
- Wiring with connector or flying leads
- Stock programm for short delivery times
- Vacuum tight

Description

This series of pressure transmitters has been carefully designed to cover the majority of industrial applications with instruments readily available from stock.

Compact design and robust construction make these instruments suitable for all applications in machine construction, process control, laboratory or quality and materials testing equipment.

There is an extraordinary range of instrument variants resulting from the fact that various mechanical and electrical connections can be combined with each other to almost any extent.

Structure

All wetted parts are made of stainless steel and are hermetically welded. Therefore there is no need for additional sealing material, which could possibly react with the pressure medium. The compact case is also made of stainless steel and provides IP 65 ingress protection (special versions up to IP 68).



Fig. left Pressure transmitter S-10

Fig. center Pressure transmitter S-11

Fig. right Pressure transmitter S-11 with cooling element

The transmitters can be supplied with a non-stabilized direct voltage of 10 (14) ... 30 V and provide standard industrial output signals.

The model S-11 with flush diaphragm is particularly suitable for the measurement of viscous fluids or media containing particulates that may clog the pressure connection of standard industrial transmitters. Thus, a trouble-free pressure measurement is ensured. Pressure transmitters with flush diaphragm are available in pressure ranges from 0 ... 0.1bar to 0 ... 600 bar. For applications with higher temperature requirements an integrated cooling element enables medium temperatures of up to 150 °C (302 °F).

For the pressure ranges from 0 ... 0.25 bar up to 0 ... 1000 bar the pressure transmitters can be delivered for oxygen applications (technical safety check of the BAM, Bundesanstalt für Materialforschung und -prüfung available).

Dimensions in mm

Electrical connections

Ingress Protection IP per IEC 60 529

L-connector,
DIN EN 175301-803, Form A
for conductor cross section
up to max. 1.5 mm²,
conductor outer diameter
6 - 8 mm,
IP 65
Order code: A4

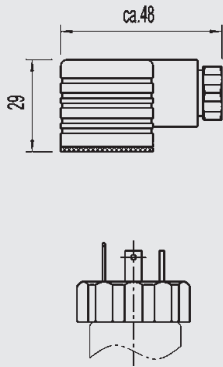

Circular connector
M 12x1, 4-pin,
IP 67
Order code: M4

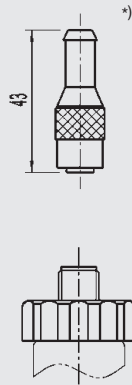

Flying leads
conductor cross section up
to max. 0.5 mm² /
AWG 20 with end splices,
conductor outer diameter
6.8 mm, IP 67
Order code: DL

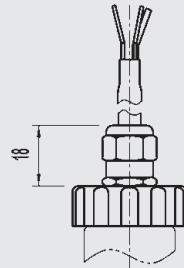

Flying leads, zero/span not adjustable
,
conductor cross section up to max.
0.5 mm² / AWG 20 with end splices,
conductor outer diameter 6.8 mm,
IP 68
Order code: EM

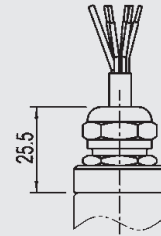

Others on request

Case

Case at 0.25 %
accuracy

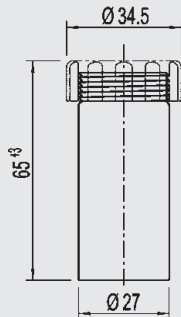

Case at 0.5 %
accuracy

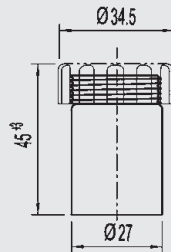

Case at 0.25 %
accuracy

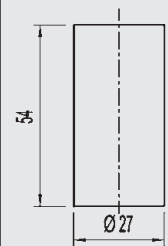

Case at 0.5 %
accuracy

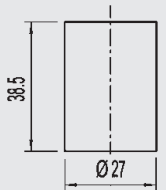

Pressure connections S-10

G 1/2
EN 837
Order code: GD

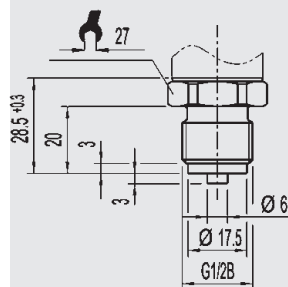

G 1/4
EN 837
Order code: GB

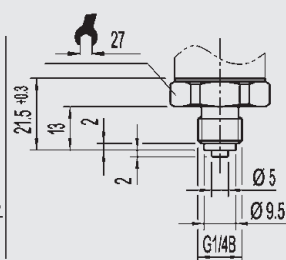

G 1/4
DIN 3852-E
Order code: HD

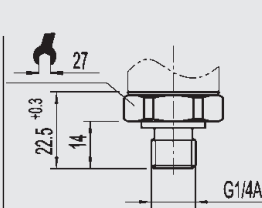

1/2 NPT
per „Nominal size for US
standard tapered
pipe thread NPT“
Order code: ND

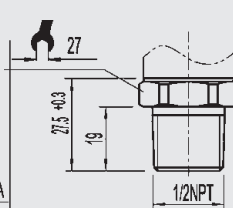

1/4 NPT
per „Nominal size for
US standard tapered
pipe thread NPT“
Order code: NB

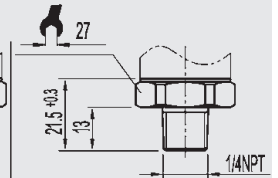

Others on request

*) Connectors are not included in delivery

Dimensions in mm

Pressure connections S-11, flush diaphragm

G 1/2 B
with or without cooling element
0 ... 2.5 up to 0 ... 600 bar
Order code: 86

G 1 B
with or without cooling element
0 ... 0.1 up to 0 ... 1.6 bar
Order code: 85

G 1 B
acc. EHEDG **)
with cooling element, up to 150 °C
up to 25 bar
Order code: 84

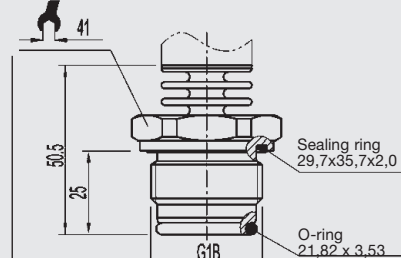
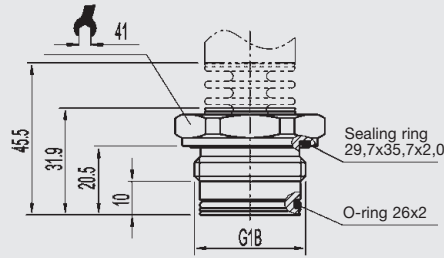
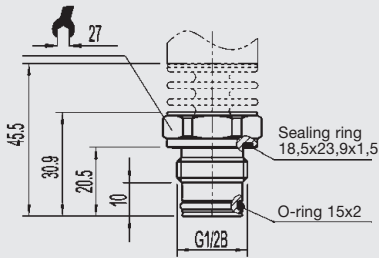



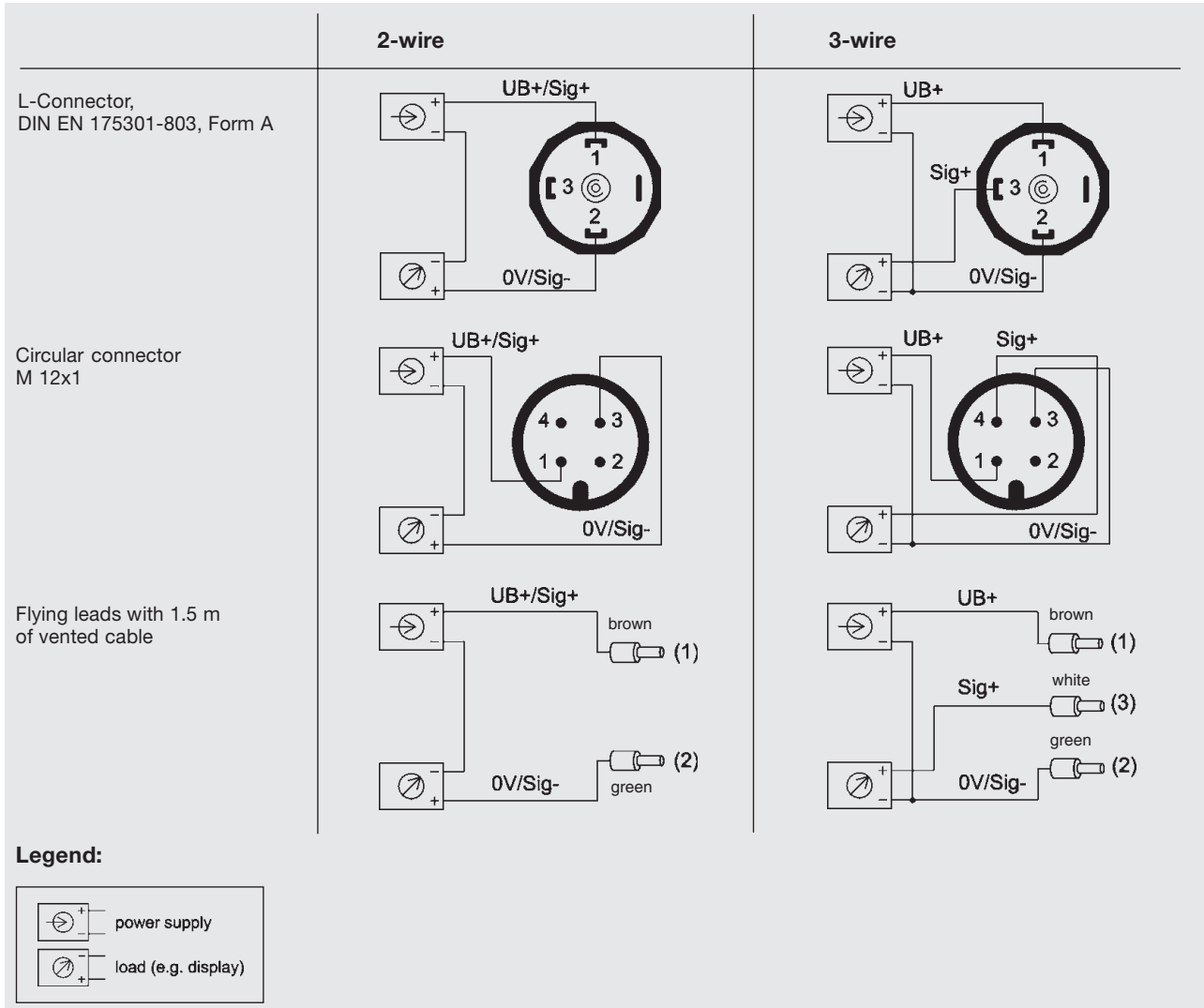

Others on request

** European Hygienic Equipment Design Group

Wiring details



Accessories

Order-No.		
		S-11
	11 92 299	G 1/2 Weld-on adaptor
	11 92 264	G 1 Weld-on adaptor
		S-10
	90 92 099	G 1/2 sealing
	90 92 161	G 1/4 sealing
		S-10
	16 04 791	G 1/2 Cooling element
		S-10
	90 92 005	G 1/2 Adaptor with insert filter
		S-10
	90 91 262	G 1/2 Throttle, max. 400 bar

Further informations

You can obtain further information (data sheets, instructions, etc.) via Internet address www.greisinger.de

Specifications and dimensions given in this leaflet represent the state of engineering at the time of printing. Modifications may take place and materials specified may be replaced by others without prior notice.